

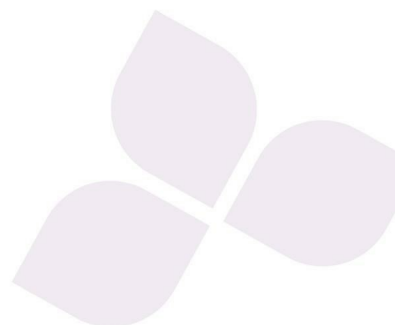

Offers In The Region Of £229,995

Palmerston Road, Southsea, PO5 3QG



HIGHLIGHTS

- ❖ COASTAL LIFESTYLE
- ❖ VIBRANT COMMUNITY
- ❖ EXCELLENT TRANSPORT LINKS
- ❖ GREEN SPACES
- ❖ HERITAGE AND HISTORY
- ❖ THRIVING DINING AND NIGHTLIFE
- ❖ PARKING AVAILABLE
- ❖ NEW CONVERSION
- ❖ LUXURY LIVING
- ❖ RESERVE TODAY

SUMMARY

We are thrilled to bring to the market this beautifully presented one bedroom apartment in Central Southsea. Boasting high ceilings, floor to ceiling windows, and exceptional finishes throughout, this home offers stylish and contemporary living in a sought after location.

Upon entering via the well designed communal areas, featuring an original marble staircase, you are welcomed into a bright entrance hall, complete with a storage cupboard and access to the fitted bathroom, featuring high end finishes and a shower over the bath.

The spacious lounge/diner offers an abundance of natural light, juliet balcony and provides the perfect space for relaxing or entertaining. The fully fitted kitchen comes with integrated appliances and has been finished to an excellent standard.

Handley's Corner in Southsea, a once thriving department store, has been beautifully transformed into modern apartments by St Cross Homes.

This stunning development blends the building's historic charm with contemporary living, offering stylish and spacious interiors designed to meet the needs of today's urban professionals. With high-spec finishes and thoughtful layouts, Handley's Corner provides residents with the perfect balance of comfort and luxury.

Located in the heart of Southsea, Handley's Corner offers unparalleled access to the area's vibrant cultural scene, independent shops, and dining hotspots.

Residents will enjoy the convenience of living in a central location, while also benefiting from the peaceful, community-focused atmosphere Southsea is known for.

transformation by St Cross Homes is set to redefine modern living in one of the most desirable neighbourhoods in Hampshire.



Call today to arrange a viewing
02392 864 974
www.bernardsestates.co.uk



3RD FLOOR
559 sq.ft. (51.9 sq.m.) approx.

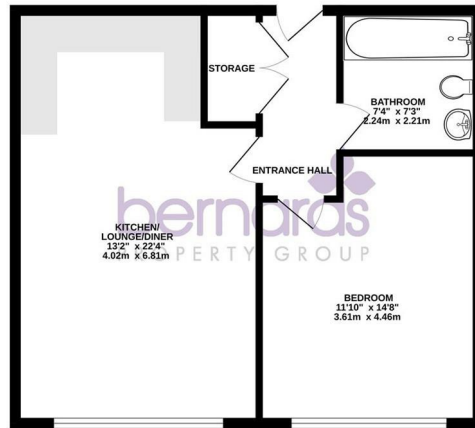

TOTAL FLOOR AREA: 559 sq.ft. (51.9 sq.m.) approx.
While every effort has been made to ensure the accuracy of the figures contained in this information, the figures are approximate and should not be relied upon for any legal or financial purposes. The actual figures for the property may vary slightly from those shown in this information. The actual figures for the property may vary slightly from those shown in this information. The actual figures for the property may vary slightly from those shown in this information.

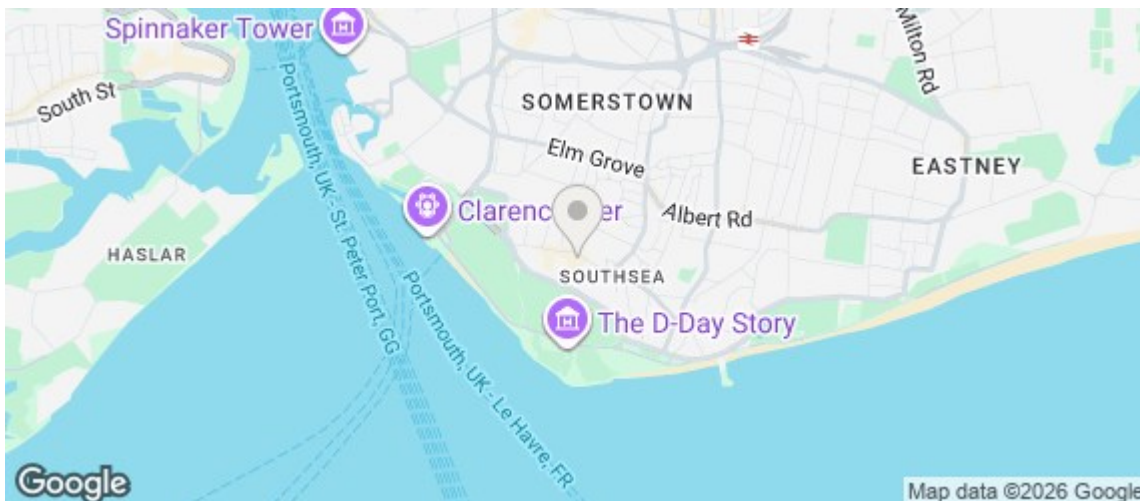

Energy Efficiency Rating		Current	Potential
Very energy efficient - lower running costs			
(92 plus)	A		
(81-91)	B		
(69-80)	C		
(55-68)	D		
(39-54)	E		
(21-38)	F		
(1-20)	G		
Not energy efficient - higher running costs			
England & Wales		EU Directive 2002/91/EC	

